

### INTRODUCTION

Lithium battery powered wireless wind speed sensor.

Robust and high durability under extreme conditions.

Exclusive use with WM44-P RF display.

Industrial RF communication 802.15.4 2.4GHz,  
world-wide license free band.

Plug & Play system.

Wide measuring range. From 2 to 200km/h.

High quality stainless steel bearings.

Maintenance free.



Robust wind speed sensor, extremely resistant and flexible, probably one of the best wind sensors in the market. Suitable for many different applications. Battery life: up to 36 months (with ER34615 19Ah). Battery not included.

Developed to be connected to display WM44-P RF. Plug & Play. No user configuration needed. More than one ANEMO4403 + RF MODULE+ WM44-P RF can operate in the same area, with no risk of interaction/interference.

Made with high quality materials. Body and cup anemometer are manufactured in technical plastic. Bearings manufactured in stainless steel.

### APPLICATIONS

Anemo4403 + RF MODULE has been designed for home and industrial applications: cranes, buildings, PV panels, wind turbines, weather

### OPERATING

Each Anemo4403 RF MODULE must be supplied with an associated WM44-P RF display. Powering WM44-P RF is the only requirement to visualize the wind speed from its associated Anemo4403 RF BAT.

#### Inputs / Outputs

From 2 to 200Km/h wind speed.

RF Communication, compliant to IEEE 802.15.4, 2.4 GHz.

## TECHNICAL CHARACTERISTICS

Power supply	Lithium battery. Size "D" 3,6V 19 Ah	Accuracy	+/-2%
Power consumption	0,6mA 5Ah / year	Transmission period	2 s
RF communication	IEEE 802.15.4. ISM 2.4 GHz Transmit Power: 10mW (10dBm) Receiver Sensitivity: -100dBm	Storage temp.	-35 °C ... +85 °C
Communication range	Indoor/Urban : 60 m max. 30 m typ. Outdoor Line-of-sight : 750 m max. 200 m typ.	Operating temp. (ice free)	-20 °C ... +60 °C
Measure range	from 2 to 200 km/h	Weight Anemo4403 + RF MODULE (w/o battery)	350 g approx.
Starting speed	8 km/h	Weight RF MODULE only	200 g approx.
		IP Rating	IP65

## CONNECTION

### Lithium battery powered

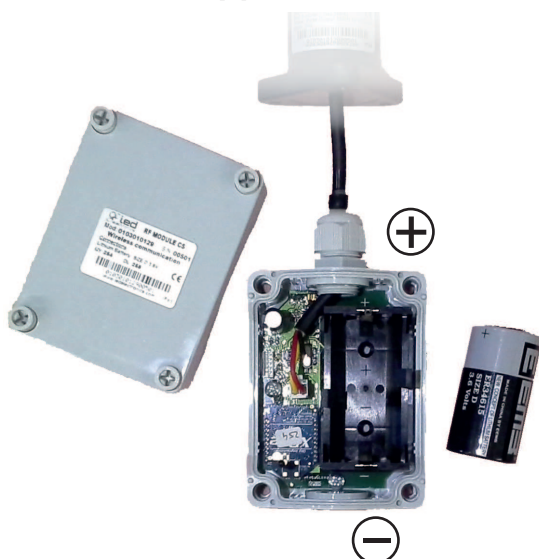

Remove the cover with a screwdriver to access the battery case.  
The lithium battery is placed on battery case.  
After the battery is fitted into the battery case, put back the cover by tightening the screws.  
NOTE: battery not included.

### Anemo4403 + RF MODULE and WM44P RF



Powering both equipments is the only requirement for operation.  
Range :  
Indoor/Urban : up to 60m.  
Outdoor : Line-of-sight up to 750 m.

## DIMENSIONS

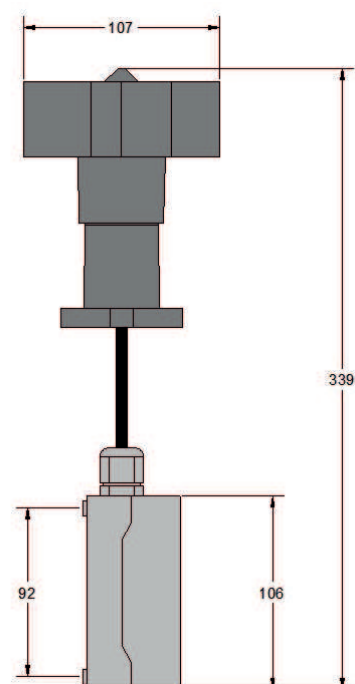
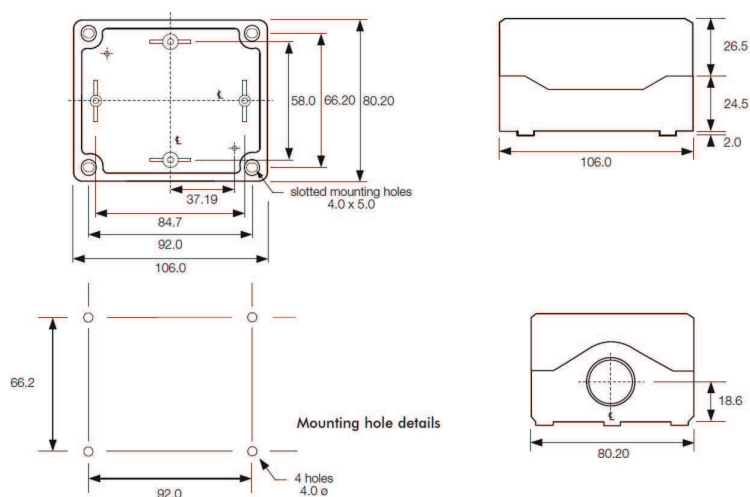

# Anemo4403 RF MODULE